

# SILENCERS

## ● NAA Series Silencers

- Compact
- Lightweight
- Durable
- 3 Thread sizes 1/8, 1/4, 3/8
- Closed-end silencer
- Maximize performance – silences pneumatic equipment without back pressure.
- Increase productivity and operator safety – reduces irritating noise, improves working environment
- Closed-end silencer – contaminants can't escape
  - maintains clean environment
  - reduces maintenance costs
  - increases equipment life



NAA Series silencers have excellent noise reducing characteristics with minimal resistance to air flow. NAA Series silencers are one third smaller than comparable products, providing considerable space savings. The large surface of the felt element resists contamination far more than other materials such as sintered bronze, steel mesh or porous polyethylene.

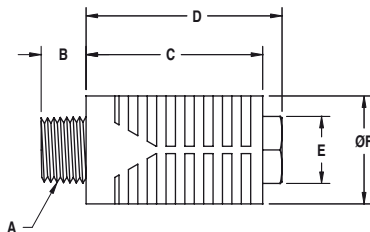

Part Number	Dimensions						Weight oz (g)	Construction				Noise Level
	A* in. (mm)	B in. (mm)	C in. (mm)	D in. (mm)	E in. (mm)	F in. (mm)		Body	Baffle	Screen	Element	
NAA2	1/8	0.23 (5.80)	0.97 (24.60)	1.08 (27.40)	0.39 (9.91)	0.61 (15.50)	0.10 (3.00)					58dB
NAA4	1/4	0.32 (8.10)	1.26 (32.00)	1.39 (35.30)	0.47 (11.94)	0.77 (19.60)	0.20 (6.00)	Nylon	Nylon	Nylon	Felt	62dB
NAA6	3/8	0.41 (10.40)	1.74 (44.20)	1.86 (47.20)	0.62 (15.75)	0.96 (24.40)	0.40 (11.00)					70dB

\*Fits NPT, BSPP and BSPT threads.

### NAA Series Silencers Operating Specifications:

**Max. Operating Pressure:** Not to exceed 150 PSI (10 bar)

**Noise level:** Measured 4.5 ft on the diagonal from the silencer while attached to a IMI Norgren pump. Noise levels will vary on IMI Norgren and non-IMI Norgren products.

**Note 1:** IMI Norgren strongly recommends the use of silencers on all vacuum pumps.

**Note 2:** IMI Norgren silencers may be used on all types of pneumatic devices i.e. air-operated vacuum pumps, air motors, valves, cylinders and more.

### How to Specify:

- **For Silencer only:** Order by Model #.
- **IMI Norgren pump/silencer combinations:** IMI Norgren recommends silencers that have been sized to ensure maximum pump performance. See specific pump for silencer options.
- **Non-IMI Norgren pneumatic devices:** The thread size on the exhaust port of the pneumatic device determines the size of the silencer.
- Equipment and applications may vary. Consult factory for proper silencer selection.

## ● NST Series Silencers

- Straight-through design
- Felt liner provides low frequency sound
- Male and female connections
- 19 models
- Reliable – straight through design – non-clogging
- Maximize performance – silences pneumatic equipment without back pressure
- Increase productivity and operator safety
- Reduces irritating noise, improves working environment
- Increase savings – reduces maintenance costs, increases equipment life



The NST Series Silencers are designed with a straight through flow path that eliminates clogging by allowing the contaminants to pass directly through the silencer. Each silencer is tuned in proportion to its exhaust flow to minimize noise.

As air passes through the silencer, the dense felt element absorbs the noise, thus reducing high pitch exhaust noise to a gentle, low frequency sound. Even in the most adverse conditions, contaminants pass through the silencer making the NST Series ideal for silencing vacuum pumps that are continuously ingesting dirt and debris.

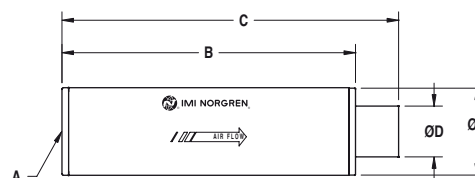

## ● NST Series Silencers: Female Threads

Part Number	Dimensions A in. (mm)	B in. (mm)	C in. (mm)	D in. (mm)	E in. (mm)	Weight oz (g)	Construction Body	Element	Noise Level
NST4AX	1/4 NPT F	3.19 (81.00)	3.56 (90.40)	0.50 (12.70)	1.00 (25.40)	1.80 (51.00)	Anodized Aluminum	Felt	75dB
NST6AX2	3/8 NPT F	2.17 (55.10)	2.55 (64.70)	0.50 (12.70)	1.00 (25.40)	1.80 (51.00)			75dB
NST6BX	3/8 NPT F	4.19 (106.40)	4.82 (122.40)	0.72 (18.30)	1.25 (31.80)	3.40 (96.00)			77dB
NST8BX	1/2 NPT F	4.19 (106.40)	4.80 (121.90)	0.73 (18.50)	1.25 (31.80)	3.10 (88.00)			76dB
NST16FC	1 NPT F	6.39 (162.30)	7.14 (181.40)	1.25 (31.80)	2.00 (50.80)	7.60 (215.00)			80dB
NST24FC	1 1/2 NPT F	7.10 (180.30)	7.85 (199.40)	1.25 (31.80)	2.00 (50.80)	7.90 (224.00)			82dB

### NST Series Silencers Specifications:

**Max. Operating Pressure:** Not to exceed 150 PSI

**Noise level:** Measured 4.5 ft on the diagonal from the silencer while attached to a IMI Norgren pump. Noise levels will vary on IMI Norgren and non-IMI Norgren products.

**Note 1:** IMI Norgren strongly recommends the use of silencers on all vacuum pumps.

**Note 2:** IMI Norgren silencers may be used on all types of pneumatic devices i.e. air-operated vacuum pumps, air motors, valves, cylinders and more.

**Note 3:** NST Silencers may be used on all IMI Norgren vacuum pumps.

**Note 4:** For Metric availability, consult factory.

### How to Specify:

- **For Silencer only:** Order by Model #.
- **IMI Norgren pump/silencer combinations:** IMI Norgren recommends silencers that have been sized to ensure maximum pump performance. See specific pump for silencer options.
- **Non-IMI Norgren pneumatic devices:** The thread size on the exhaust port of the pneumatic device determines the size of the silencer.
- Equipment and applications may vary. Consult factory for proper silencer selection.

## ● NST Series Silencers: Male Threads

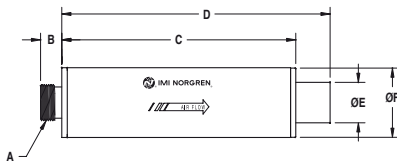

Part Number	Dimensions							Weight	Construction		Noise
	A	B	C	D	E	F		oz (g)	Body	Element	Level
	in. (mm)	in. (mm)	in. (mm)	in. (mm)	in. (mm)	in. (mm)					
NST2	1/8 NPS M	0.30 (7.60)	0.63 (16.00)	1.00 (25.40)	0.20 (5.10)	0.44 (11.20)		0.20 (6.00)	Acetal	N/A	68dB
NST4	1/4 NPS M	0.30 (7.60)	1.49 (37.80)	1.86 (47.20)	0.35 (8.90)	0.75 (19.10)		0.60 (17.00)	Acetal	Felt	68dB
NST4A	1/4 NPS M	0.37 (9.40)	3.19 (81.00)	3.56 (90.40)	0.50 (12.70)	1.00 (25.40)		1.80 (51.00)	Anodized Aluminum	Felt	70dB
NST4A2	1/4 NPS M	0.37 (9.40)	2.18 (55.40)	2.56 (65.00)	0.50 (12.70)	1.00 (25.40)		1.40 (40.00)	Anodized Aluminum	Felt	72dB
NST6A	3/8 NPS M	0.38 (9.70)	3.19 (81.00)	3.56 (90.40)	0.50 (12.70)	1.00 (25.40)		1.80 (51.00)	Anodized Aluminum	Felt	72dB
NST6B	3/8 NPS M	0.38 (9.70)	4.19 (106.40)	4.82 (122.40)	0.72 (18.30)	1.25 (31.80)		3.10 (88.00)	Anodized Aluminum	Felt	72dB
NST8A	1/2 NPS M	0.38 (9.70)	3.19 (81.00)	3.56 (90.40)	0.50 (12.70)	1.00 (25.40)		1.80 (51.00)	Anodized Aluminum	Felt	74dB
NST8B	1/2 NPS M	0.38 (9.70)	4.19 (106.40)	4.82 (122.40)	0.72 (18.30)	1.25 (31.80)		3.10 (88.00)	Anodized Aluminum	Felt	76dB
NST12C	3/4 NPS M	0.34 (8.60)	6.18 (157.00)	6.93 (176.00)	1.25 (31.80)	2.00 (50.80)		7.80 (221.00)	Anodized Aluminum	Felt	80dB
NST16C	1 NPS M	0.50 (12.70)	6.18 (157.00)	6.93 (176.00)	1.25 (31.80)	2.00 (50.80)		7.70 (218.00)	Anodized Aluminum	Felt	80dB

Note: All NPS threads fit G Port threads

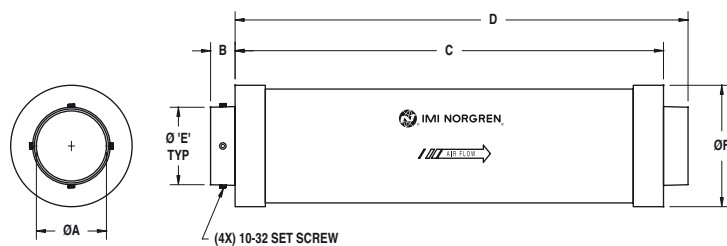

Part Number	Dimensions							Weight	Construction		Noise
	A	B	C	D	E	F		oz (g)	Body	Element	Level
	in. (mm)	in. (mm)	in. (mm)	in. (mm)	in. (mm)	in. (mm)					
NST2020	Ø 1.99							11.00 (311.00)			
NST2020-5	Ø 1.24	0.70 (17.80)	12.23 (310.60)	12.93 (328.40)	2.21 (56.10)	3.46 (87.90)		13.30 (377.00)	PVC	Foam	82dB
NST2020-7	Ø 1.49							12.70 (360.00)			

## ● NSTAA Series Silencers

- Compact
- Lightweight
- Durable
- Ultra quiet operation
- 2 Thread sizes 1/4, 3/8 NPT
- Maximize performance – silences pneumatic equipment without back pressure
- Increase productivity and operator safety
- Reduces irritating high pitch frequency noise
- Improves working environment
- Maintain clean environment – reduces maintenance costs, increases equipment life

A hybrid silencer that offers increased noise reduction by combining an NST silencer with an NAA silencer. The (closed-end) NAA silencer is attached to the end of a modified NST silencer, thus removing the flow through feature of the standard NST Series silencers.

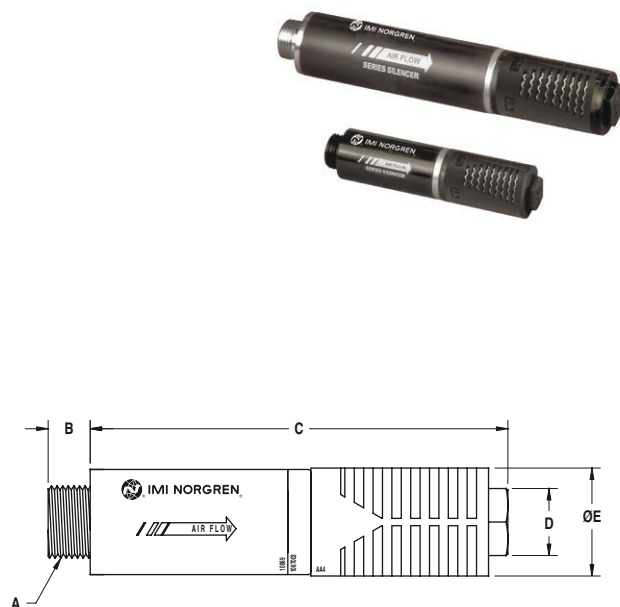

Model #	Dimensions A in. (mm)	B in. (mm)	C in. (mm)	D in. (mm)	E in. (mm)	Weight oz (g)	Construction Body	Baffle	Screen	Element	Noise Level
NSTAA4	1/4 NPS M	0.30 (7.60)	2.96 (75.20)	0.48 (12.20)	0.47 (11.90)	0.70 (20.00)	Acetal/ Nylon	Felt/ Nylon	Nylon	Felt	58dB
NSTAA6	3/8 NPS M	0.38 (9.70)	5.15 (130.80)	0.63 (16.00)	0.62 (15.70)	1.80 (51.00)	Aluminum/ Nylon				64dB

### NSTAA Series Silencers Specifications:

**Max. Operating Pressure:** Not to exceed 150 PSI [10 bar]

**Noise level:** Measured 4.5 ft on the diagonal from the silencer while attached to a IMI Norgren pump. Noise levels will vary on IMI Norgren and non-IMI Norgren products.

**Note 1:** IMI Norgren strongly recommends the use of silencers on all vacuum pumps.

**Note 2:** IMI Norgren silencers may be used on all types of pneumatic devices i.e. air-operated vacuum pumps, air motors, valves, cylinders and more.

**Note 3:** For Metric availability, consult factory.

### How to Specify:

- For Silencer only: Order by Model #.
- **IMI Norgren pump/silencer combinations:** IMI Norgren recommends silencers that have been sized to ensure maximum pump performance. See specific pump for silencer options.
- **Non-IMI Norgren pneumatic devices:** The thread size on the exhaust port of the pneumatic device determines the size of the silencer.
- Equipment and applications may vary. Consult factory for proper silencer selection.

## ● NFA-51 Series Silencers

- Closed-end
- 3 Thread sizes 1/4, 3/8, 1/2
- Replacement elements available
- Safe – closed-end high flows won't cause potentially dangerous projectiles
- Quiets large vacuum pumps, valves, cylinders, air motors, and more
- Durable – more area inside to absorb sound and debris
- Economical – lasts longer, lower cost, replacement elements available
- Reliable – no back pressure on high flow applications
- Maintain clean environment – reduces maintenance costs, increases equipment life



The NFA-51 Series silencers offer remarkable noise reduction for high volume exhaust applications without causing back pressure. These silencers are ideal for quieting large air valves that must exhaust quickly to maintain high cycle rates. IMI Norgren uses the FNA-51 silencers on all high flow venturi vacuum pumps where even a small amount of back pressure would decrease performance.

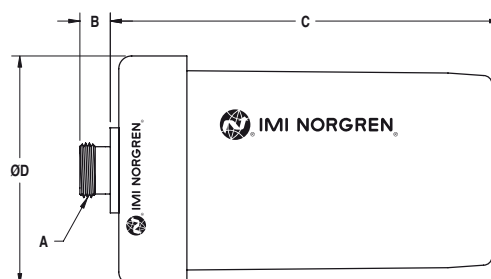

Part Number	Dimensions A* in. (mm)	B in. (mm)	C in. (mm)	D in. (mm)	Weight oz (g)	Construction Body	Baffle	Screen	Element	Noise Level
NFA-51-.250	1/4 NPS M	0.30 (7.60)								
NFA-51-.375	3/8 NPS M	0.38 (9.60)	5.74 (145.80)	3.36 (85.30)	12.70 (357.00)	Steel	Foam	Steel	Paper	72dB
NFA-51-.500	1/2 NPS M	0.38 (9.60)								
NRF-51	N/A	N/A	4.76 (120.90)	3.03 (77.00)	6.20 (176.00)					

### NFA-51 Series Silencers Operating Specifications:

**Max. Operating Pressure:** Not to exceed 150 PSI [10 bar]

**Noise level:** Measured 4.5 ft on the diagonal from the silencer while attached to a IMI Norgren pump. Noise levels will vary on IMI Norgren and non-IMI Norgren products.

**Note 1:** IMI Norgren strongly recommends the use of silencers on all vacuum pumps.

**Note 2:** IMI Norgren silencers may be used on all types of pneumatic devices i.e. air-operated vacuum pumps, air motors, valves, cylinders and more.

### How to Specify:

- **For Silencer only:** Order by Model #.
- **IMI Norgren pump/silencer combinations:** IMI Norgren recommends silencers that have been sized to ensure maximum pump performance. See specific pump for silencer options.
- **Non-IMI Norgren pneumatic devices:** The thread size (1/4, 3/8, 1/2) on the exhaust port of the pneumatic device determines the size of the silencer i.e. NFA-51-.250
- **P/N: NRF-51 - Replacement Element:** Fits all NFA-51 models
- Equipment and applications may vary. Consult factory for proper silencer selection.