

NPT MALE X NPT MALE ADAPTERS

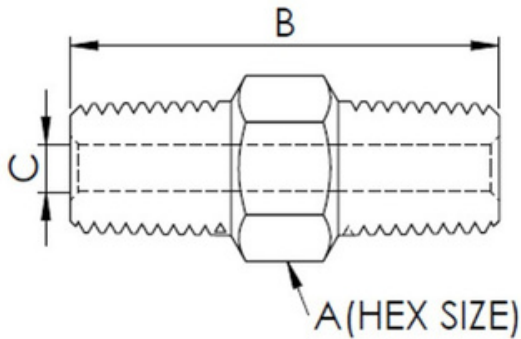

DESCRIPTION	PART NUMBER	PSI	(A) HEX	(B) OAL	(C) THRU	LBS
1/16 NPT M X 1/16 NPT M	X1N01N15	15,000	0.375	1.00	0.110	0.02
1/16 NPT M X 1/8 NPT M	X1N02N15	15,000	0.500	1.20	0.110	0.04
1/8 NPT M X 1/8 NPT M	X2N02N15	15,000	0.500	1.28	0.140	0.05
1/8 NPT M X 1/4 NPT M	X2N04N15	15,000	0.625	1.38	0.140	0.08
1/8 NPT M X 3/8 NPT M	X2N06N15	15,000	0.750	1.43	0.140	.011
1/4 NPT M X 1/4 NPT M	X4N04N15	15,000	0.625	1.48	0.187	0.09
1/4 NPT M X 1/4 NPT M 3" X4N04N-3-15	X4N04N-3-15	15,000	0.625	3.00	0.187	0.23
1/4 NPT M X 1/4 NPT M 6" X4N04N-6-15	X4N04N-6-15	15,000	0.625	6.00	0.187	0.50
1/4 NPT M X 3/8 NPT M	X4N06N15	15,000	0.750	1.53	0.187	0.12
1/4 NPT M X 1/2 NPT M	X4N08N15	15,000	0.875	1.68	0.187	0.18
1/4 NPT M X 3/4 NPT M	X4N12N10	10,000	1.125	1.90	0.187	0.32
1/4 NPT M X 1 NPT M	X4N16N10	10,000	1.375	2.19	0.187	0.58

CONTINUED...

THE INFORMATION CONTAINED IN THIS DRAWING IS THE SOLE PROPERTY OF ONEHYDRAULICS. ANY REPRODUCTION IN PART OR AS A WHOLE WITHOUT THE WRITTEN PERMISSION FROM ONEHYDRAULICS IS PROHIBITED.

NPT MALE X NPT MALE ADAPTERS

CONTINUED...

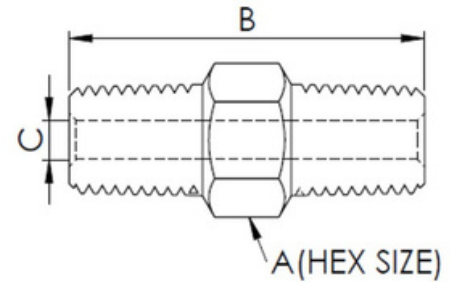

DESCRIPTION	PART NUMBER	PSI	(A) HEX	(B) OAL	(C) THRU	LBS
3/8 NPT M X 3/8 NPT M	X6N06N15	15,000	0.750	1.58	0.312	0.13
3/8 NPT M X 3/8 NPT M	X6N08N15	15,000	0.875	1.73	0.312	0.19
3/8 NPT M X 3/4 NPT M	X6N12N10	10,000	1.125	1.95	0.312	0.33
3/8 NPT M X 1 NPT M	X6N16N10	10,000	1.375	2.24	0.312	0.59
1/2 NPT M X 1/2 NPT M	X8N08N15	15,000	0.750	1.43	0.140	.011
1/2 NPT M X 1/2 NPT M 3"	X8N08N-3-15	15,000	0.875	3.00	0.375	0.41
1/2 NPT M X 1/2 NPT M 4"	X8N08N-4-15	15,000	0.875	4.00	0.375	0.57
1/2 NPT M X 1/2 NPT M 6"	X8N08N-6-15	15,000	0.625	6.00	0.187	0.50
1/2 NPT M X 3/4 NPT M	X8N12N10	10,000	1.125	2.10	0.375	0.37
1/2 NPT M X 1 NPT M	X8N16N10	10,000	1.375	2.39	0.375	0.62
3/4 NPT M X 3/4 NPT M	X12N12N10	10,000	1.125	2.20	0.550	0.40
3/4 NPT M X 1 NPT M	X12N16N10	10,000	1.375	2.49	0.550	0.66
1 NPT M X 1 NPT M	X16N16N10	10,000	1.375	2.65	0.687	0.76
1 NPT M X 1-1/4 NPT M	X16N20N07	7,500	1.750	2.90	0.687	1.27
1 NPT M X 1-1/2 NPT M	X16N24N07	7,500	2.00	2.99	0.687	1.58
1 NPT M X 2 NPT M	X16N32N07	7,500	2.500	2.99	0.687	2.49

THE INFORMATION CONTAINED IN THIS DRAWING IS THE SOLE PROPERTY OF ONEHYDRAULICS. ANY REPRODUCTION IN PART OR AS A WHOLE WITHOUT THE WRITTEN PERMISSION FROM ONEHYDRAULICS IS PROHIBITED.