

- > **Port size: 1/8 NPT, G 1/8**
- > **System pressure (unit bar, psi, Mpa, KPa, kgf/cm², mmHg, InHg or mmH₂O) selectable**
- > **Rohs compliant**
- > **High accuracy and resolution**
- > **Switching status indicated by LED**
- > **Output: 2 x PNP**
- > **IP65**



Technical features

Medium:

For filtered, lubricated or non lubricated compressed air, neutral and incombustible gases

Pressure range:

-14.5 to 145 psi (-1 to 10 bar)
-14.5 to 14.5 psi (-1 to 1 bar)

Display:

3 1/2 digit LED

Mounting position:

Optional

Repeatability (switch output):

≤ ±0.2% of full scale ±1 digit - without temperature sensitivit

Response time:

±2.5 ms

Shock proof:

100g (980 m/s²), xyz

Vibration proof:

88g, 10 - 55 Hz, xyz

Degree of protection acc. to DIN 40050:

IP65 (with mounted dust proof protector)

Weight:

3 oz. (83g)

Temperature sensitivity:

≤ 2% of full scale (FS) of detected pressure 77°F (25°C)

Ambient/Media temperature:

32°F to 122°F (0°C to 50°C)

Storage temperature:

-4°F to 140°F (-20°C to 60°C)
No condensation or freezing
Air supply must be dry enough to avoid ice formation at temperature below + 35°F (+2°C)

Materials:

Body: PC

Electrical parameters

Electrical connection:

M12 x 1

Power supply:

12 to 24 VDC
24 VDC (PNP) maximum

Residual voltage:

≤ 1 V (load current 80 mA)

Permissible residual ripple:

10% or less (P-P)

Current consumption:

≤ 50 mA

Load current:

80 mA maximum (with output short circuit protection)

Switching mode:

PNP

Indicator:

Green LED (OUT1), Red LED (OUT2)

Insulation resistance:

50 MΩ min at 500 VDC (between case and lead wire)

Electromagnetic compatibility:



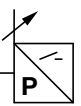

According to EN 61326-1

Technical data

| Symbol | Port size | Switching pressure range (psi) | Switching pressure range (bar) | Output signal | Model |
|---|-----------|--------------------------------|--------------------------------|---------------|-------------------------|
|  | G 1/8 | -14.5 to 145 | -1 to 10 | 2 x PNP | 0860810000000000 |
| | 1/8 NPT | -14.5 to 145 | -1 to 10 | 2 x PNP | 0860811000000000 |
| | G 1/8 | -14.5 to 14.5 | -1 to 1 | 2 x PNP | 0860820000000000 |
| | 1/8 NPT | -14.5 to 14.5 | -1 to 1 | 2 x PNP | 0860821000000000 |

*1) Short-term pressure peaks are not allowed to exceed this limit value during operation. Operative utilization of the limit value is not permitted. The limit value corresponds to the maximum testing pressure

Accessories

| Panel mounting kit** | | | | |
|---|---|---|---|---|
| Mounting bracket (wall mounting) | Mounting bracket (bottom mounting) | Panel adapter | Front protective lid | Mounting (DIN rail clip) |
|  |  |  |  |  |
| 0860000000000000 | 0860001000000000 | 0860002000000000 | 0860003000000000 | 0860007000000000 |

** The Panel mounting kit consists of two part numbers: **0860002000000000** and **0860003000000000**. **BOTH** numbers must be ordered for the mounting kit to function.

Electrical connection M12 x 1

| | PIN-No. | Signal | Cable |
|--|---------|--------|-------|
| | 1 | + UB | brown |
| | 2 | Out 2 | white |
| | 3 | - | blue |
| | 4 | Out 1 | black |

PNP

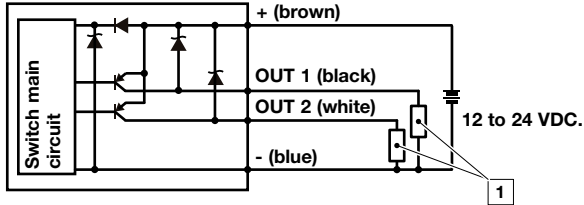

Pressure switch

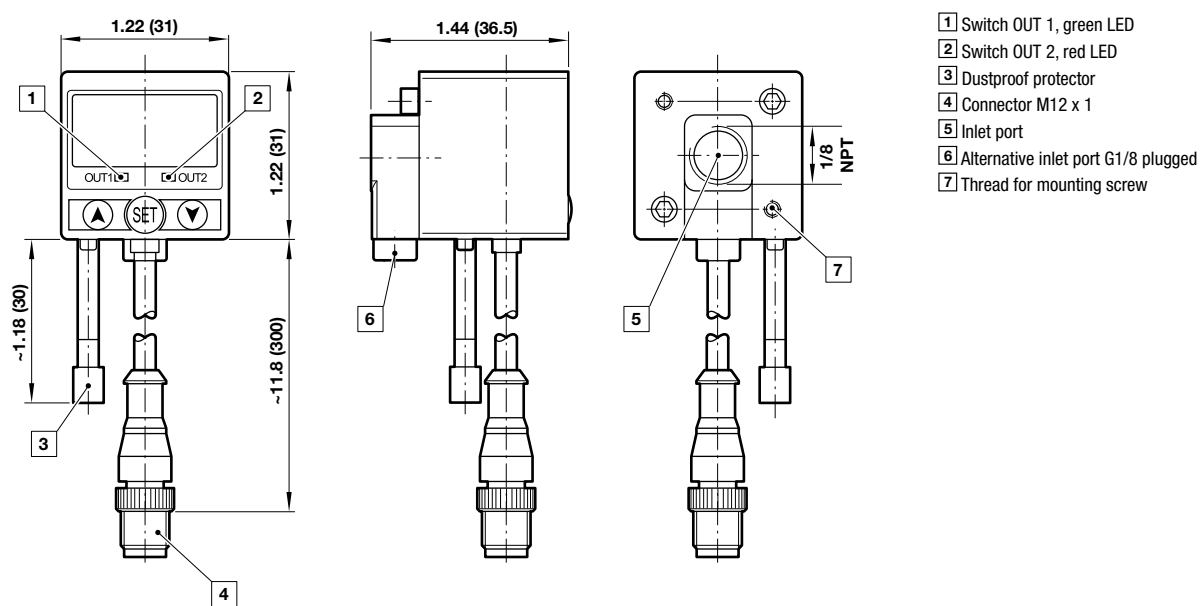

Mounting bracket (wall mounting)

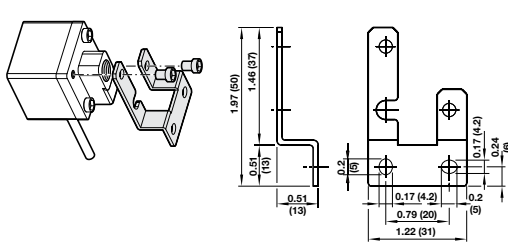

Mounting bracket (bottom mounting)

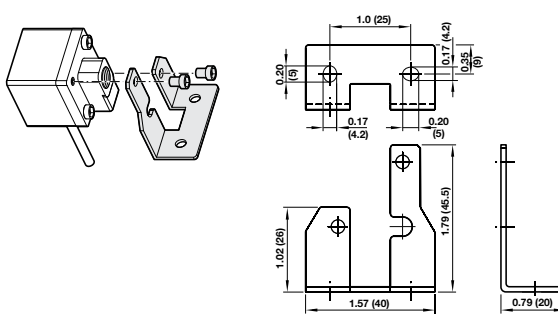

Panel mounting kit

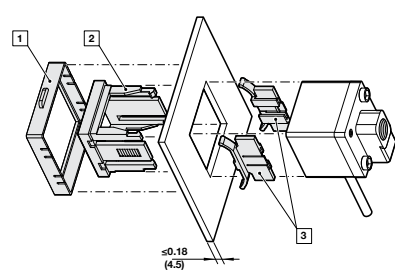

Front protective lid

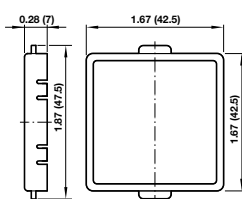

Panel adaptor

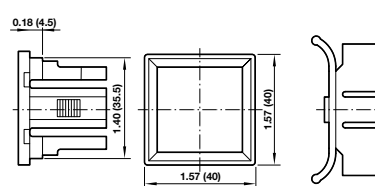

- 1 Front protection lid
- 2 Panel adaptor
- 3 Safety adaptors

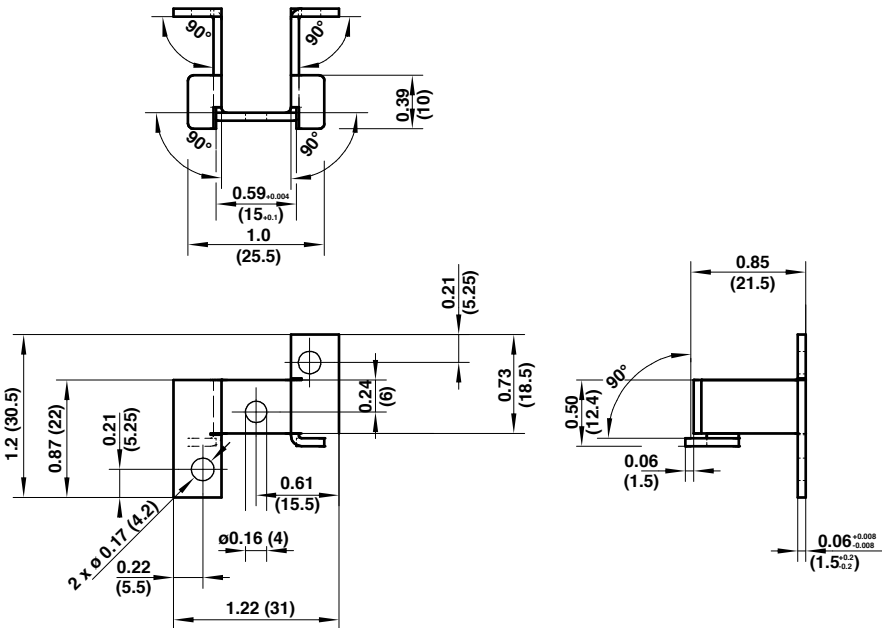
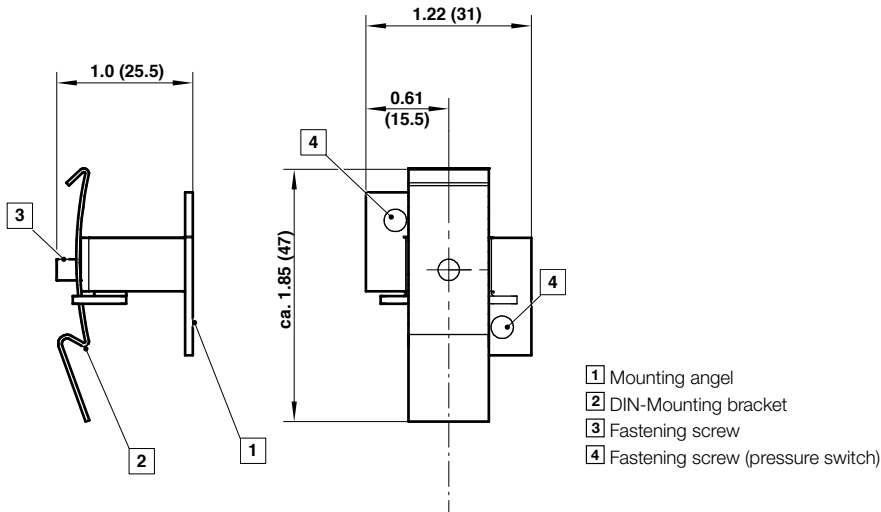
Drawing - Mounting (DIN rail clip)

Warning

Improper selection, misuse, age or malfunction of components used in systems can cause failure in various modes. The system designer is warned to consider the failure modes of all component parts and to provide adequate safeguards to prevent personal injury or damage to equipment or property in the event of such failure modes. System designers and end users are cautioned to consult instruction sheets and specifications available from the factory. The system designer/end user is responsible for verifying that all requirements for the application are met.

Proposition 65

This product may contain chemicals known to the state of California to cause cancer, birth defects, or other reproductive harm.

Warranty

The products described herein are warranted subject to seller's Standard Terms and Condition of Sale, available at seller's website.